



PROGRESS ON SITE AT THE SHERWOOD FOREST VISITOR CENTRE (PHOTO COURTESY OF WOODHEAD GROUP)



A computer generated image of the proposed extension to DARC

TALES OF THE RIVERBANK

Working on behalf of the Durham Amateur Rowing Club (DARC), we have submitted a Planning application for an extension to their riverside boathouse at the end of Green Lane within Durham City, for an extension to provide additional training space and boat storage.

Founded in 1860, the club is now a thriving community for all ages and all abilities of rowers but held back from further development through the physical constraints of the site, bounded by the River to the east and land owned by Durham University to the west and north with access via a single lane track. In addition, the new clubhouse, completed in 2007, includes an education centre, conference facilities for a wide variety of functions, parties and corporate events with the all important

training rooms for rowers and storage facilities for the boats.

Project Architect, Stuart Franklin, explained the application, "The club was a victim of its own success with increasing numbers of members wanting increasing access to limited facilities - the project provides an additional single storey boat store attached to the existing boat house's west elevation, and a new fitness room and terrace on top of the existing boat store's flat roof with associated balustrading and external escape stair."

"The challenge has been to firstly minimise the visual impact of the new development as viewed from the river, hence locating the boat store behind the existing taller club house and setting back the first floor extension to reduce

Mark Bell, Manager of DARC, commented,

"We are very pleased with the design concepts developed by JDDK to answer our design brief. We feel the design complements the existing facilities well and delivers a much more attractive view of the building from the riverside aspect which is also part of the busy Weardale Way foot and cycle paths. The extra space will allow us to expand our activities and set the club up for the next generation of rowers in Durham with an excellent facility to support rowing at all levels."

its apparent mass, which has also allowed an east facing roof terrace overlooking the river. Secondly, as the site is within a flood plain the new boats store has been purposefully designed to allow the flow of flood waters through it so minimising risks of flooding elsewhere as a result of the development."

A FOND FAREWELL... David Kendall, who retired in March



David Kendall

David's career began at Newcastle University in 1976 but even then, the quality of his portfolio of sketches had reduced the University's entrance criteria to just two 'E' grades at A Level as his talent was obviously recognised at an early stage.

He remains as modest now as he was then, referring to his career as 'incredibly lucky' - "I was supported throughout by amazing teachers, amazing colleagues, amazing clients and an amazing family who allowed me to work in the way I thought best rather than being forced into other areas."

Like so many students, David stayed in Newcastle after finishing his first degree in 1979 and worked for a year in the Newcastle office of Ralph Erskine Arkitektkonter AB, a period which enormously influenced his approach to architecture, "I loved Newcastle from Day One - there was so much going on and the quality of life was light years above other cities. Working with the Byker Wall team was an incredible experience where I learnt so much about exercising humility in design and the psychology of the interface between private and public spaces."

Byker was followed by a year at the prestigious Royal Academy of Fine Art in Copenhagen studying Urban Design under Professor Jan Ghel and learning how to make streets living entities, as he explained, "The course taught me that understanding the underlying social and psychological issues were the most important factors in designing urban environments - the actual style etc. was simply the gloss on the surface, whilst it was also crucial to understand the natural environment so that people in the urban environment could interact with it. In practical terms, this could be as simple as orienting spaces and openings to face the sun - a North facing courtyard will remain forever cold and empty!"

"I learnt so much about exercising humility in design."

Newcastle would be the only place for his second degree, graduating in 1983, and joining Jane Darbyshire at her Gosforth practice, a working relationship which would develop to eventually become Jane Darbyshire & David Kendall Ltd in 1990 after a brief separation to work for Ryder Nicklin for two years in 1987.

David's approach to projects has remained constant as he explained, "One of our first large urban regeneration projects was around Union Square in North Shields - a large, mixed use scheme which involved demolition, new build, historic building restoration and landscaping of public spaces - it was challenging and exciting and relied on a great team working together and creating something special through good design and attention to detail. The result really transformed that area of the town."

"Our work for Rivergreen Developments on projects like the Rivergreen Centre, whilst completely different, relies on similar teams of people who can deliver the designs through their skill, and I think that's the basis of architecture - exercising your skill for the benefit of clients and users of buildings and spaces. But you can only do this if the client allows the creative process and this is where I've been so lucky in working with superb clients and colleagues, even though I've sometimes been known as a control freak because the details are so important!"

As to the future, David will be spending more time painting, continuing his apprenticeship in gardening and following his interest in live music, whilst also spending time with his 20 month old granddaughter.

David's work across a range of sectors, including a leading role in progressive, environmentally low-impact design, has been recognised by a number of regional and national awards. His contribution to the growth and reputation of the practice has been immense and we look forward to staying closely in touch and we wish him the very best of success in whatever areas his natural talent takes him.

"I'm eternally optimistic about architecture - I know that the design process is increasingly supported by the use of technology and software products but where better to start than a sheet of paper where you can sketch ideas? However, you have to understand construction to be able to design successfully - the appearance, scale and perception of a building can only come after knowledge of how a building is put together. I was lucky to work with really technically minded architects and technicians like Tony Reynolds and Kevin Turnbull with whom I had a constant dialogue when designing and I think this is vital."

David Kendall

DESIGNING FOR CHANGING NEEDS

Durham Aged Mineworkers' Homes Association (DAMHA) is working with its development partner, Karbon Homes, to build 19, two bedroom bungalows at Abbey Drive in Houghton Le Spring in a £2.7m housing scheme designed especially for older residents.

Established in 1898, DAMHA is the largest almshouse charity in the country with over 1,700 homes for residents over 50 years old across the NE region, many of whom have mobility problems. The Association was recently highly praised by the Homes & Communities Agency for both its governance and the high quality of the affordable homes it provides.

The layout of the Abbey Drive scheme has been orientated to give residents both security, with gable bay windows overlooking footpaths, and a 'green' feel with generous landscaping. Each bungalow enjoys its own private garden and dedicated parking bay in addition to areas of common amenity space.



The 19 bungalow scheme for Durham Aged Mineworkers Housing Association

It is, however, also the internal layouts that will prove attractive to residents, as JDDK Director and Project Architect, Mura Mullan, explained, "The bungalows are designed in line with The Lifetime Homes Guide and are laid out to provide two bedrooms with generous kitchen and living spaces but can be adapted to meet potentially changing needs, offering the scope for people to remain in their homes for as long as possible, thereby reducing the pressure on health and social care systems."

DAMHA Chief Executive, Paul Mullis, commented,

"We look forward to continue working with Sunderland City Council to provide sustainable and affordable accommodation in the area."

"The site on Abbey Drive gives us a fantastic opportunity to provide high quality bungalows for which there is a strong demand in this area of Houghton Le Spring whilst the innovative design will create homes for life for the residents."



The Rivergreen Centre, Durham



Jesmond Dene House, Newcastle



Bellevue House, Durham

PRESTON NEUROLOGICAL CARE CENTRE

In March we secured planning permission on behalf of Sue Ryder for an innovative Neurological Care Centre in the Eastway development area in North West Preston.



The proposed Sue Ryder Neurological Care Centre at Preston

The scheme proposes an innovative rehabilitative and therapeutic 40 bed neurological care centre for adults with complex medical conditions such as multiple sclerosis, motor neurone disease and acquired brain injury.

In addition, there will be two pairs of semi-detached bungalows for residents needing either continued rehabilitation for their recovery or for those with complex care needs who require one to one support to enable them to live life to their full potential in a safe, secure and homely environment.

Both the care centre and supported living units will provide specially designed bedrooms and en-suites featuring overhead tracking hoists, extra width corridors to accommodate specialist wheelchairs, and the use of specialist therapy spaces including a hydrotherapy pool, physio gym and rehabilitation kitchen.

This unique service will be the first of its type in Lancashire supporting an identified need within the community.

The surrounding residential development has influenced the scale of the main building which is divided into three, 12-14 bed houses across 2.5 storeys with a nursing hub on each floor enabling nursing staff to provide care to all bedrooms. Day services, the gym and hydrotherapy pool, offices and the cafe are located to the ground floor, with further staff facilities to the first floor, whilst the smaller second floor is purely for resident bedrooms and nursing facilities.

This 2.5 storey height is in keeping with the approved residential development on the adjoining site, helping the proposals sit within the character of the wider Eastway masterplan. Indeed, the Sue Ryder scheme

Terry Mears, Care Centre Director at Sue Ryder, commented:

"We're delighted to have gained Planning Permission for this scheme and are looking forward to the construction phase. The JDDK design is perfect answer to our brief for a much needed facility to provide the very best Neurological Care for the North West region."

will act as a gateway to the wider residential development of which it forms an important part and creates a first impression for the whole site when approached from the West.

Construction on the development will begin this Summer by Seddon Construction.

EXPANSION FOR WEAR REFERRALS



A CGI of the new Phase 3 to the right of the original award-winning development

Acting on behalf of our clients, Wear Referrals, we have applied for Planning Permission for a third phase of expansion to the Veterinary Hospital at Bradbury, near Sedgfield in County Durham.

The hospital provides a highly specialised service for small animal specialist diagnostics, treatment and surgery by referral from other veterinary practitioners from the M62 up to Glasgow and Edinburgh. Phases 1 & 2 of the scheme were built concurrently and completed three years ago in the Spring of 2015, going on to win the Built Environment, Sustainability and Outstanding Awards in the 2105 Durham County Environmental Awards.

Since then, Wear Referrals' business has grown exponentially, leading to a demand

for additional clinical, administrative and staff space as they grow to become one of the UK's leading veterinary specialist centres working 24 hours a day, 7 days a week with staff working in shifts with around 70 employees on site at any one time.

Located directly to the west of the original development, Phase 3 mirrors the original scheme's graceful curves so that they appear as a coherent whole, contemporary in design but sympathetic to the rural setting. The internal layout incorporates similar design

principles that worked so well in Phase 1 of promoting the efficient flow of staff and patient movement through the spaces as well as separating staff support facilities and customers from clinical spaces.

The application for Phase 3 proposes a connecting corridor, enhanced education spaces, staff welfare and study areas in addition a dog exercise yard and south facing customer areas and staff welfare facilities with views over open fields.

RUTHERFORD CANCER CENTRE



The Rutherford Cancer Centre in Bomarsund

February the 6th saw an important milestone at the Rutherford Cancer Centre in Bomarsund with the arrival on site of the 55 tonne cyclotron which generates the proton beams used in proton therapy. The therapy uses a high-energy beam of protons rather than x-rays to deliver radiotherapy for patients, reducing the risk of damage to the surrounding healthy tissues.

Our design for the centre included a removable section of roof through which the equipment was very carefully lowered into place.

Situated at the Earth Balance wellness site in Bomarsund, Northumberland, the site is the second to be built by Proton Partners International in the UK with construction work beginning in August 2016. The centre will be able to treat up to 500 patients every year and, in addition to proton therapy, will offer imaging, chemotherapy, traditional radiotherapy and well-being services. The centre is expected to open later this Summer.



The vault at the Rutherford Centre with the cyclotron in place

Professor Karol Sikora, Chief Medical Officer of Proton Partners International, commented:

"The delivery of this proton therapy machine to the Rutherford Cancer Centre North East will make innovative and groundbreaking cancer treatment available to patients across England."

"This advanced proton therapy technology will transform the lives of many thousands of cancer patients with its very precise form of treatment and will mean that patients who need proton therapy will not have to travel abroad in future to receive it."

PROGRESS AT SHERWOOD FOREST VISITOR CENTRE

There's been some great progress at the £5.3m Sherwood Forest Visitor Centre project where, despite the recent bad weather, our contractor, Woodhead Group, is on track to handover the project to the RSPB-led consortium, which includes the RSPB, the Sherwood Forest Trust, Continuum Attractions and Thoresby Estate working together with Nottinghamshire County Council, later this Summer.

The front cover aerial photo shows the structure taking shape after the glulam frame had been secured during December. The curved, twisted form, created by staggered roof beams, is now taking shape and reflects the forest environment and the "Trees that sheltered him" concept of Robin Hood.

JDDK Principal Architect, Alison Thornton-Sykes, commented,

"The linear format will pull visitors through the initial welcoming area for visitors into the main building with retail and recreation facilities to wilderness zones to give visitors a real sense of the ancient forest environment. They then exit the Centre down through a 5m level change into the double height café space and out to the exterior amphitheatre sheltered by the overhanging canopy, an integral part of the roof."



Glazing work at the Visitor Centre in March



The Sill: National Landscape Discovery Centre at Once Brewed in Northumberland

SHORTLISTING FOR RTPI, RICS, RIBA AND PLANNING AWARDS

February saw The Sill shortlisted for the RTPI (Royal Town Planning Institute) National Awards in the Excellence in Planning for Heritage and Culture category, and for the RICS (Royal Institute of Chartered Surveyors) NE Awards in the Community Benefit and Tourism & Leisure categories. Our designs for the Byker Hobby Rooms were also shortlisted in the RICS NE Awards in the Building Conservation and Regeneration categories. In March the Sill has been further shortlisted for a regional RIBA Award and a national Planning Award in the category Design Excellence.

The Sill opened to the public on July 29th and has since received acclaim from many of the 100,000 visitors who have visited the centre in its first seven months and Northumberland businesses. The building has also been the result of a truly local enterprise, with more than 3,000 local residents taking part in the extensive community consultations during the design period and 90% of

the construction employment coming from within the region.

For many, the most striking feature is the Whin Sill grass roof, planted to replicate the unique natural grasslands of the surrounding area, which sweeps gently upwards, giving visitors a bird's eye vantage point across one of the UK's most magnificent landscapes and the UNESCO World Heritage Site of Hadrian's Wall.

JDDK Principal Architect, Alison Thornton-Sykes commented, "The whole team are absolutely delighted to have been shortlisted for these prestigious awards - whether The Sill wins or not, it's a testament to the incredible amount of careful planning and design that went into not only the actual building but also the whole concept of the Landscape Discovery Centre."

LAKESIDE HOMES AT BOMARSUND

Our proposals, on behalf of Orca LGS Solutions Ltd, for seven unique lakeside homes at the Earth Balance site in Bomarsund have received full planning permission.

Located just to the South of the Rutherford Cancer Centre (see page 4), the four bedroom, two storey detached homes have been designed as an integral part of the overall vision for the Earth Balance site. This is to provide not only sustainable housing, but also training, education and employment during the construction phase. With their innovative Light Gauge Steel (LGS) frames, normally reserved for commercial construction projects, the project enables ORCA to engage and train unskilled workers in the off-site manufacturing, assembly and on-site installation of the structures.



The seven new homes will enjoy a stunning Lakeside location

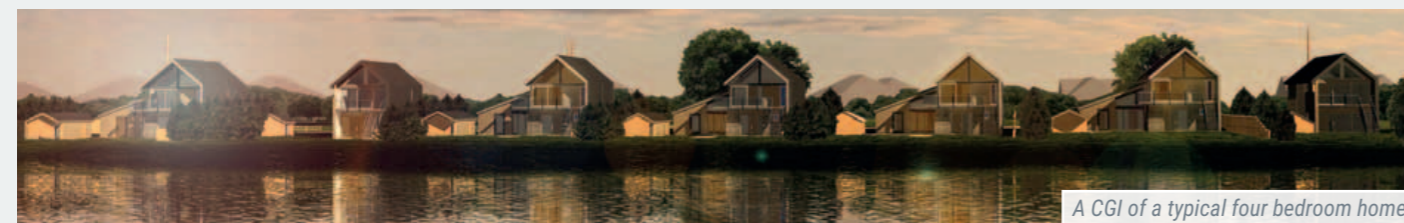

A CGI of a typical four bedroom home

JDDK Director, Nicky Watson, explained the design: "The contemporary design of the homes maximizes the lakeside location with east facing living accommodation with access to a balcony with steps down to the Lakeside garden. Ground floor stone-filled gabions form a substantial base to the light weight glazed and timber-like clad upper floors embedding the building comfortably in its landscaped setting whilst Sedum roofing on the single storey lean-to section enhances the natural setting and the ecological value of the development."

CHESTER GATE PLANNING APPLICATION



Four bedroom semi-detached home at Chestergate

Our planning application for phase one of a flagship housing development in Sunderland on behalf of Gentoo Homes was submitted in February.

The £74m Chester Gate housing scheme in Sunderland features 500 new homes available to both buy and rent and will be 'unlocked' by the construction of a new access from Chester Road, which will be part of Sunderland City Council's £2m highway improvement work as part of the scheme.

The site holds a prominent position on Chester Road at one of the main gateways into the city from the A19 and improvement works to Chester Road will be carried out later this year, subject to planning approval, with construction work likely to begin on site at the beginning of 2019.

Redevelopment of the vacant land is hugely important for the continued regeneration and transformation of Sunderland's housing offer, diversifying the type of housing on offer to both existing residents and people looking to move into the city.

This initial application is for the first phase of the project, worth £17.7m, which features 118 new and contemporary three and four bedroom homes available to buy.

JDDK Director, Nicky Watson, commented, "The proposed development on this prominent sloping site is an opportunity to generate a new image for the area and create a high quality "gateway" into the city. At key locations contemporary and well balanced elevations have been designed to create a modern, vibrant and active frontage. Top floor feature openings are designed facing south to take advantage of the views."

"The rest of the scheme will feature a number of different designs of two, three and four bedroom house types using a similar mixed palette of materials and detailing and is planned to maximise south facing views from the high parts of the site. Working alongside Cundall and Southern Green we have developed proposals that will create high quality and accessible landscaped public spaces and streetscapes

that enhance the ecological value of the site and take full advantage of the uniqueness of character that the incorporation of over ground water retention basins and the changes in levels of the site bring to the development."

Keith Loraine OBE, Gentoo Group's chair, commented:

"We are hugely excited about the prospect of the new Chester Gate development and are immensely proud to play a key role in Sunderland's ongoing transformation in to a modern and prosperous 21st century city. "Our plans to redevelop the site represent a huge investment for Gentoo and this once again demonstrates our commitment to providing much needed new housing in Sunderland."

Proposed frontage to Chester Road



CIVIC SUCCESS



The bungalows at Welbeck Close

We were double winners at the prestigious Lord Mayor's Design Awards held on 30 January, winning both the Accessibility and Refurbishment categories with schemes to provide supported housing at Welbeck Close in Walker for Karbon Homes and the conversion of NBS's Old Post Office in Newcastle.

The Welbeck Close housing in Walker has seen the construction of five, two bedroom bungalows designed specifically for residents with autism or learning difficulties and one staff bungalow in a secure development with just one single point of entry adjacent to the staff office. The bungalows are detached to avoid issues of sound transmission and feature flexible internal layouts with three currently equipped with baths and two with a fully accessible wet room.

The Refurbishment Award is for the very different conversion of Newcastle's Old Post Office. Originally constructed in the 1870's, the building became a major employer and focal point of the City before closing in 1999 as a result of Royal Mail restructuring and being split up into a variety of office uses.

Our design has returned the Grade II listed building to its original unified state creating space for NBS's 200



Newcastle's Old Post Office

plus staff who have been brought together across two main floors. The building named 'The North's coolest office' now contains some 3,500m2 of offices, meeting rooms and extensive staff facilities.

Mura Mullan, JDDK Director, added, "We're absolutely delighted to have won these two prestigious awards for projects right on our doorstep. Whilst the difference between the two projects shows the width of the practice's expertise, the common factors of evidence-based design and placing the end-user at the centre of the design process is common. Both Karbon Homes and NBS were wonderful clients to work for and with whom we built a great working relationship."

CONGRATULATIONS...

...to Stuart Franklin and his son, Sam, for completing the gruelling Annapurna Circuit from 23 March to 9 April - some 140 kms around Annapurna in Nepal which takes in the famous Thorong La Pass at a lung-busting 5,416 metres height!

The trek, rated by many as one of the best in the world, travels anti-clockwise around Mt Annapurna with walkers resting in lodges overnight. Sam will be raising money and awareness for St Oswalds Hospice and hopes to return to Nepal next year to volunteer in a community build project providing new accommodation for houses affected in the 2015 earthquakes.

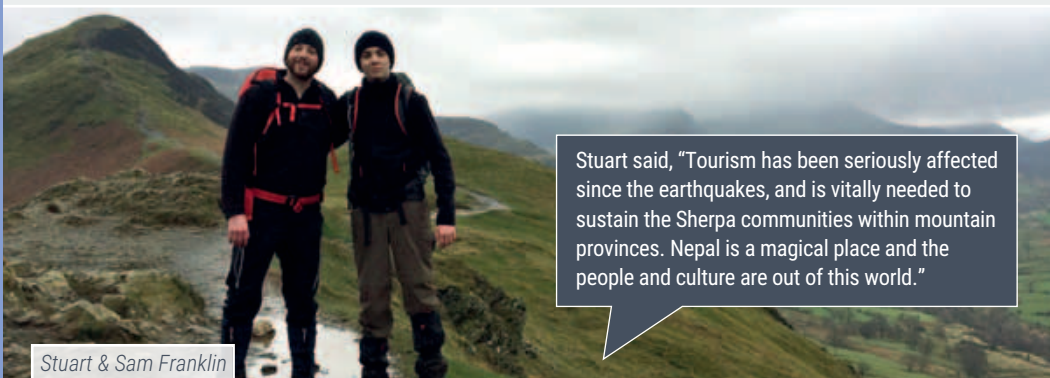

Stuart & Sam Franklin

Stuart said, "Tourism has been seriously affected since the earthquakes, and is vitally needed to sustain the Sherpa communities within mountain provinces. Nepal is a magical place and the people and culture are out of this world."

STOP PRESS

The Sill received its 100,000th visitor on March 8th, just eight months after opening in July last year and some five months ahead of schedule.



The Sill

PEOPLE'S PASSIONS WALKING ON THE WILD SIDE

I love walking in the Lake District and, fortunately, so does my husband, Nathan, and we're not giving young Noah much choice about the matter as he comes too!

I started 'serious' walking around 2004 with a group of old school friends and we've just carried on, so that as a family we try to get over to the Lakes for a week once a year, preferably out of the peak tourist season when it gets too crowded, and doing some of the great walks it has to offer. This year we've hired a cottage at Grasmere which is really handy for the Fairfield Horseshoe which is a fantastic walk.

Whilst the high peaks are great and very dramatic, some of the low level walks are just as fulfilling for me as they don't rely on good visibility (often a rarity on the peaks) to appreciate the stunning scenery.

I think my favourite is around the Langdale Valley, a seemingly quiet route forever known to us as the Trouser Walk through my brother being disturbed while changing into his shorts by two bus loads of tourists...

Nathan actually proposed to me on the shores of Derwentwater, so although we've walked in Scotland and Wales, I think we'll always come back to the Lakes - I just hope Noah likes it too!



Clair and family enjoying the Lake District

JDDK DISCOVER DESIGN DELIVER

jddk.co.uk

t. 0191 286 0811

e. millmount@jddk.co.uk

JDDK Architects

Millmount, Ponteland Road

Newcastle upon Tyne NE5 3AL