



THE SILL: NATIONAL LANDSCAPE DISCOVERY CENTRE AT ONCE BREWED IN NORTHUMBERLAND

BRIAR DENE BRINGS NEW ENGLAND TO WHITLEY BAY



The new Briar Dene in Whitley Bay

Sir John Fitzgerald's £1.6m refurbishment of the Briar Dene public house in Whitley Bay opened in time for the Spring Bank Holiday, bringing a fresh offering to the North East family restaurant sector.

Enjoying a superb sea-facing location on the Links, the pub had closed in early 2015 for an intended refurbishment but was then severely damaged by fire in August 2015 in a set back that only delayed the project rather than end it due to the commitment and determination of the Sir John Fitzgerald team.

Our design has involved the total internal refurbishment of the Briar Dene into a family restaurant and pub with a Fish Bar for take-away meals to the rear. Extensions

dating from the 1950's and 1960's have been demolished to restore the pub to its original form but with the installation of state-of-the-art catering facilities and a new plant room. A new manager's apartment and storage areas are located on the first floor.

Externally, a hard landscaped South West facing beer garden and veranda gives even more room to customers whilst a timber effect to the first floor has recreated the clapboard style of New England seaside properties.

Sir John Fitzgerald currently operate 15 establishments within the North East region and their latest investment in this family restaurant with an unique Fish Bar has already created over 30 jobs.

JDDK Associate Director and Project Architect, Stuart Franklin, commented,

"There's been a public house on the site for around 100 years so it's great to ensure this will continue in the future, albeit in a modern format that reflects the importance of family oriented restaurants. The New England look creates a really interesting addition to the coastline whilst the investment in plant and catering equipment will ensure the Briar Dene will be ahead of any regulations for many years to come."



The South West corner of the refurbished Briar Dene



The same view prior to refurbishment

The project included total internal refurbishment



NEW FAMILY HOME FOR SENSITIVE BAMBURGH LOCATION



CGI of the private house in Bamburgh

Earlier this year we secured planning permission from Northumberland County Council, for a new private house in Bamburgh village under the shadow of the historic castle.

The highly sensitive location in a Conservation Area lies between the historic and Grade II listed Armstrong House, originally designed in 1914 as a rest home for workers in Lord Armstrong's Tyneside factories and now a

rest home managed by the Abbeyfield Group, and the Grade I listed Bamburgh Castle, required an equally sensitive design.

The design is a mainly single storey elongated form to create an extended backdrop in the character of a south facing garden wall. The core of the house is two storeys, accommodating two bedrooms with en-suite facilities on the first floor and one on the ground floor.

JDDK Director, Kevin Turnbull, commented:

"Our planning application was on behalf of a local family who now required a three bedroom family dwelling - a modern home with minimal visual impact in a historic setting which took advantage of the gently sloping site aspect and superb outlook. Our design response to the heritage significance of the site was crucial to our successful application with the design subservient yet sympathetic to Armstrong House and reflecting the landscape and heritage significance of the site."

"Of prime importance was the need to protect the visual association between Armstrong House and Bamburgh Castle so that Armstrong House could be viewed from the castle and vice versa. The design therefore placed the low profile home to the north of the available site with materials selected to blend in with those of the adjacent buildings and vehicle parking and access discretely hidden from view. The stepped roof profile with varying ridge and eaves heights, combined with retained existing trees effectively screens the property from the Castle retaining a line between these historically connected buildings."

PHASE ONE OF BYKER HOBBY ROOMS PROJECT COMPLETES

As we go to press Esh Property Services are completing work on the first phase of the conversion into new apartments of 10 of the 84 'Hobby Rooms' within the Byker estate.

The scheme follows an in depth feasibility study conducted by the practice leading to the development of strategic proposals after consultation with the local community.

JDDK Director and Project Architect, Nicky Watson, explained, "Whilst the Byker Wall of apartments is the most famous part of Ralph Erskine's ground breaking and now Listed development, also included amongst the 1,200 houses to the south of the Wall are some 84 'Hobby Rooms', designed to retain the strong sense of community spirit and cohesion within the new Byker estate of the 1970's."

"Over recent years there has been considerable investment in the housing stock on the estate but virtually no investment in the Hobby Rooms. Whilst a small proportion of the 84 spaces were well used and in reasonable condition, the vast majority have fallen into a poor state of repair and many are under used."

The new one bedroom contemporary studio home at 28a Raby Way



28a Raby Way before the conversion work



"As part of the Feasibility Study, after consultation with the local community, we proposed that 48 (55%) of the rooms could be refurbished and retained for community activities including storage, 21 (24%) could be used to extend existing adjacent dwellings (in some cases to provide wheelchair accessible accommodation), 11 (12%) could be refurbished into new dwellings (again including the creation of much needed wheelchair accessible dwellings), whilst 4 (5%) could be refurbished for commercial/social enterprise use."

Typical of the conversions is 28a Raby Way which has been converted into a one bedroom studio home now available for rent to meet the current and future needs of the community.

Michelle Bell, Director of Property and Development at Byker Community Trust, commented:

"It has been a pleasure to work with the JDDK team and their flair and dynamism have enabled us to make considerable progress so far. The initial findings of the feasibility study helped us to plan our investment programme for the future to maximise the use of the Hobby Rooms for the benefit of the Byker residents. Considerable work has been put in by JDDK and their team to get us from feasibility to completing works to these Listed buildings on site and it's wonderful to see the finished results which enhance the Estate and the housing opportunities it offers."

PUBLIC APPROVAL FOR THE SILL

The Sill: National Landscape Discovery Centre at Once Brewed in Northumberland, opened to the public on July 29th and has since received acclaim from visitors and Northumberland business.



The Sill: National Landscape Discovery Centre

Made possible by money raised by National Lottery players, the project is the result of an innovative partnership between Northumberland National Park Authority and YHA (England & Wales). The Heritage Lottery Fund awarded a National Lottery grant of £7.8million towards The Sill project to help transform how people connect with the landscape.

The 18 month construction programme of our design for the Northumberland National Park Authority (NNPA) and YHA (England & Wales), began in late 2015. On its opening weekend, The Sill had over 5,000 visitors with superb reviews for both the facilities and building itself.

Named after the adjacent Great Whin Sill, the volcanic crag on which Hadrian's Wall is partly built, the building forms the heart of a seven-year investment plan to increase visitor numbers to the Northumberland National Park and Hadrian's Wall World Heritage sites.

The facility has been designed as a showcase of local pride and passion, featuring an exhibition space, learning and event spaces, a local produce café, rural business hub, a world-class 86 bed Youth Hostel and a shop specialising in local crafts and produce.

But, for many, it's the actual building that is the main attraction. The result of a truly local enterprise, with more than 3,000 local residents taking part in the extensive community consultations during the design period and 90% of the construction employment coming from within the region, the most striking feature is the Whin Sill grass roof, planted to replicate the unique natural grasslands of the surrounding area. The Sill's fully accessible living roof sweeps gently upwards, giving visitors a bird's eye vantage point across one of the UK's most magnificent landscapes and the UNESCO World Heritage Site of Hadrian's Wall.



The local produce café enjoys magnificent views



A central atrium provides daylight in to the heart of the building

JDDK Principal Architect, Alison Thornton-Sykes, commented:

"The Sill is inspired by The Great Whin Sill, Northumberland's internationally-renowned geological feature, and grows from the landscape that surrounds it. An aerial view of the wider landscape shows these dramatic geological

outcrops as diagonal ripples in the landscape. The building is developed as another ripple rising out of the landscape so that the diagonal flowing lines of the building echo the natural undulations and outcrops in the landscape."

"We hosted a series of open events and workshops where we discussed site layout,

materials and architectural style. The participative design process gave the local community a chance to get involved, voice their opinions and feel some ownership of the project. It also allowed us to draw on a vast wealth of local knowledge and expertise."



The Sill's fully accessible living roof

28,439 people visited The Sill during August alone

Tony Gates, Chief Executive of Northumberland National Park Authority, commented:

"The unique concept and rural location of The Sill: National Landscape Discovery Centre, located in a National Park and within the Hadrian's Wall World Heritage Site presented challenges which required experienced and high-quality architectural design services. JDDK took the building from a list of required uses through an extensive and detailed public engagement process, establishing a public desire for a modern design response in this key heritage location. This has ultimately led to a building in and of the landscape, with its very fabric drawn from the land within which it sits. I am incredibly proud of what has been achieved."

"The Sill is the largest project of its kind undertaken by a National Park anywhere in the country. Its opening weekend was a huge success and the very first stepping stone towards achieving our vision to excite, inspire and enable people of all ages to understand and explore the landscapes, history, culture and heritage of Northumberland."

The building has also been designed on sustainable principles to target a BREEAM Very Good rating, including orientation to maximise on solar gains in some of the public spaces while offices are placed to the north to prevent overheating. A central atrium provides daylight in to the heart of the building while allowing a summer time natural ventilation strategy and mechanical ventilation with heat recovery in the winter.

The south facing entrance canopy provides solar shading to the glazed frontages of the classrooms and main entrance while also supporting photo voltaics for generating electricity. Solar panels are also incorporated on the Youth Hostel roof to provide hot water

while the remaining whin sill vegetation roof increases biodiversity and reduces surface water runoff. The building also incorporates high levels of insulation and air tightness, low embodied energy materials and enhanced ecology including habitats for bats and birds.

As such, the building harmoniously reflects the distinctiveness of the Northumbrian landscape in both its shape and the materials used in its construction, rising from the Northumberland landscape with little impact on the environment, perfectly mirroring its inspiration; the unique landscape of the Hadrian's Wall corridor. 80% of the external walls of the building are finished in local materials including whin stone, sandstone and native larch.

The facility includes an extensive exhibition space



Inside a typical two bed room in the youth hostel





The proposed Highford Grove development

HIGHFORD GROVE OFFERS UNIQUE HOMES

In early September, Country Homes & Estates (Mitford) Ltd, launched their innovative Highford Grove development for sale through Savills Estate Agents.

Adjacent to the Grade II listed Highford Bridge and flanked by Scotch Gill Wood Nature Reserve, the South facing development sits within a bend of the River Wansbeck overlooking Borough Wood. Our design is for an informal grouping of eight detached, two storey stone-built homes with generous gardens screened by the existing mature trees. Plot sizes vary from 0.25 to 1.4 acres, the largest two plots enjoying woodland river frontage and fishing rights.

Chris Carlisle, Managing Director of Country Homes & Estates (Mitford) Ltd, commented, "It's a cleverly laid out development of superb homes in a truly rural setting of some 5.5 acres. The eight plots, with full planning permission,



Street scene at the proposed Highford Grove development

were released for sale on September 9th with prices ranging from £330,000 to £425,000 and we took the first two reservations on the opening weekend. Each purchase price secures the freehold of a fully serviced plot with pre-approved planning permission for

a five bedroom, stone built home with a double garage and extensive garden. After purchase, each plot's new owners are invited to work with JDDK and the developer in creating their perfect new home."

ARCHITECTURE AMBASSADOR ROLE FOR JDDK

In July we took part in the Royal Institute of British Architects (RIBA) Architecture Ambassadors programme to inspire pupils at St Teresa's School in Heaton and give them an insight into the world of architecture.

Designed to inspire a passion for architecture in the next generation, the programme involved JDDK's Principal Architect, Alison Thornton-Sykes, with fellow architect Sam Dixon linking with the school to talk about their work in a special workshop on Linking Structures and set the Year 5 pupils a brief to create their own structure which would link aspects of the natural or built environment.

Alison explained the project, "It's as much about inspiring children to think about their built and natural environment as it is about promoting architecture as a career. In the workshop we explain what an architect does and illustrated this with two of our current projects, The Sill in Northumberland and the RSPB-led partnership's Sherwood Forest Visitor Centre which is due to open next year. Both projects are intimately linked with their immediate environments - the trees of Sherwood Forest and the Whin Sill landscape of The Sill - so they are great examples of linking structures."



Children of St Teresa's Primary School celebrate their 'Linked Structure' project with JDDK Architects' Alison Thornton-Sykes.

"But what we really wanted to see is how the children view linking structures, whether this is their local Heaton Park, their own Forest School, or further afield and their projects certainly didn't disappoint showing incredible imagination and real skills - they were terrific!"

St Teresa's Acting Head Teacher, Sheila Jackson, commented:

"The programme was a great success which really inspired our students and fired their imaginations."

COLLABORATIVE DESIGN FOR ALDER HEY



Alison Thornton-Sykes



Stuart Franklin



Otis Murdoch



Matt Holmes



The JDDK design for Alder Hey Bereavement Counselling Centre

We were delighted to be shortlisted in May for the design of the new Bereavement Counselling Centre at Alder Hey Children's Hospital in Liverpool as one of just five architectural practices nationwide.

The RIBA competition was for a £1m centre to provide bereavement counselling for families who have lost a child, as well as a national telephone helpline and general counselling for hospital staff. The Centre will eventually occupy a prominent plot overlooking Springfield Park which is currently occupied by vacated former hospital buildings due to be demolished.

JDDK Principal Architect, Alison Thornton-Sykes, explains the design, "By its very nature, this was to be a highly sensitive building and we decided that our design would respond to the park location with tree-like structures leading up to a stepped roof terrace and containing informal 'den-like' meeting areas."

"While not selected as the winning scheme, the competition gave the office the opportunity to work together and test new ideas. What's great about JDDK is the collaborative spirit so a few of us got together as a group for the design process, each bringing different skills and approaches."

"I started with making models using cocktail sticks stuck into plasticine and sketches, then

Stuart Franklin built a far more detailed model, whilst Otis Murdoch developed the design digitally using Dynamo Studio, a programme which extends design possibilities. The software provides a programming environment that enabled us to create visual logic from code and translate it to 3D to explore 'parametric' (unique parameter based geometric relationships) conceptual designs. The software capability was invaluable in producing the complex geometries required for the design delivery."

"Matt Holmes then used more traditional Revit software to further develop the design and show how it could be built with the 'tree roots' or wigwam structures containing central meeting spaces, and ring beams on which the structural elements are supported."

"We had just a short time to work on the entry but it showed that by working as a team, we could pull such a great design together."

3D CGI using Dynamo Studio software

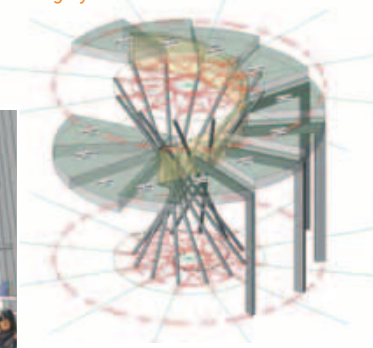

Proposed interior view

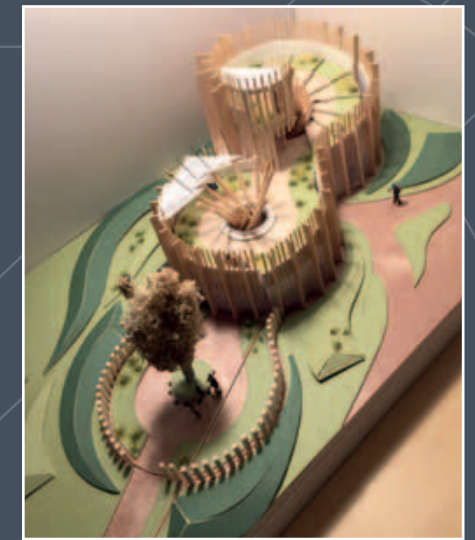

Stuart's detailed models of the proposed Centre

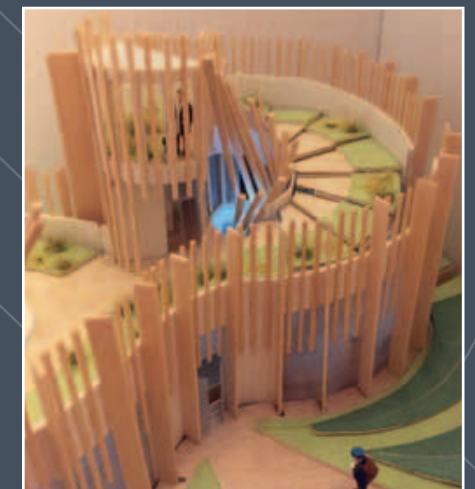

MATT'S MAGNIFICENT MARATHON



*Matt Holmes at Land's End
(it may say 874 miles, but
that's as the crow flies...)*

If you complained at all about the weather at the end of April, spare a thought for JDDK Associate Director, Matt Holmes who spent 12 days at that time solo cycling LEJOG - up from Land's End to John O'Groats in a 12 day, 1,200 mile marathon effort that has so far raised over £2,000 for Diabetes UK.

Inspired by other cyclists and a friend's struggle with diabetes, Matt completed the 1,274 miles from the 15th to the 26th of April, climbing and descending a total of 22,290 meters - over twice the height of Mt Everest!

Matt commented, "I only decided to do it after a chance meeting with another cyclist who had done the challenge on a whim and thought, "if he can do it then so can I!" I based the route mainly around the Sustrans National Cycle Network and Youth Hostels, starting in Cornwall and Devon, where most of the hills are, and ending in Scotland which is actually much flatter on the route I chose going alongside the Lochs in the main. There's no official route as riders choose their own way taking in areas that they personally want to see. I'd arranged to see a few friends on the way and 'pop in' to see our project The Sill at Bardon Mill."

"It's still a really strange feeling buying a single rail ticket to Penzance and realising you're totally on your own to make your way to the other end of the country! It was a fantastic experience, however, with lows and highs - battling against a 45 mph head wind and thundering logging trucks on the incredibly dangerous A82 running alongside Loch Ness was definitely a low point whilst reaching the finish was a tremendous feeling I'll never forget. In the main, though, it was the people I met and their kindness that will stay with me - café owners that wouldn't take any money for meals once they saw I was doing a charity ride, total strangers that donated after chatting to me and the incredible JDDK team at The Sill in Northumberland who gathered to greet me!"

Congratulations To...

Jake Jardine for successfully completing an Intermediate Level apprenticeship in Business Administration and BTEC Level 2 diploma in Business Administration. Jake, from High Farm near Wallsend, joined us in 2016 as Trainee Administrative Assistant and has had the benefit of Angela Cowens' and Romanda Jobson's expertise in learning the complexities of looking after the practice's administrative affairs.



Jake and his certificates

Welcome To...

Olie Hopwood, who joins us as an Architectural Assistant whilst he works towards his Part III RIBA qualifications. Originally from Cheshire, Olie is a double architectural graduate from Northumbria University with a particular interest in sustainable architecture and well-being and now lives in Heaton. Inspired to a career in architecture partly through a passion for design and partly through watching Kevin McCloud's 'Grand Designs', he commented, "I'd met Nicky Watson through University and knew the practice's work well, so was delighted to be asked for an interview and am really enjoying the work and being part of the friendly team here at Millmount."



Olie Hopwood

PEOPLE'S PASSIONS ANDY RUTHERFORD'S FAMILY COOKING

It was my Mum and the Be-Ro Flour recipe books which first started me cooking and it's my family, Mura and our two girls Holly and Louise, that keep me enjoying it!

I think home-made food is far tastier, more nutritious and obviously cheaper than any prepared dishes with the added advantage that it's good fun (mostly...) and brings the whole family together to help cook and to eat the results.

I'm in an Internet spice club and have fresh spices delivered which really make such a difference to curries (Coconut Dahl is our favourite) and other dishes whilst Mura's also hooked with the Hello Fresh packages of ingredients you can get delivered now.

Apart from the curries, we like to keep the dishes simple so that we can all enjoy them - the girls have such busy weekends with their activities that we can't sit down to eat together as often as we'd like, but when we do, it's so much better to eat dishes we've produced ourselves!

*Andy's Thai
Massaman Rice with
roasted aubergine and
chestnut mushrooms.*



Chef Rutherford

The tools of the trade...

JDDK DISCOVER DESIGN DELIVER

jddk.co.uk

t. 0191 286 0811

e. millmount@jddk.co.uk

JDDK Architects

Millmount, Ponteland Road

Newcastle upon Tyne NE5 3AL